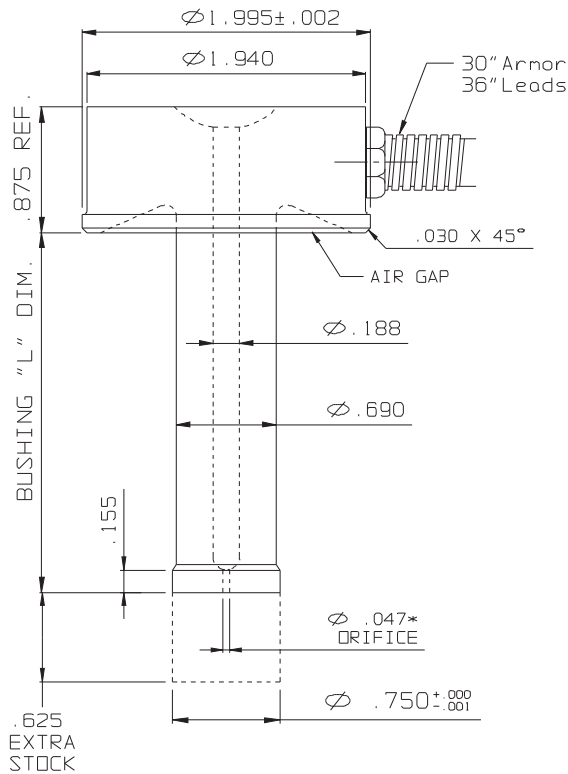

.750 & 1.000 DIA. BUSHINGS

 MAT'L: H-13
 33-35 Rc.

.750 DIA. SPRUE BUSHING

STANDARD SIZES

L	½ SPH. RAD.	¾ SPH. RAD.	FLAT TYPE	Watts	Volts	T/C
1.500	MB7523-50	MB7523-75	MB7523-38	310	240	J2-06
2.000	MB7527-50	MB7527-75	MB7527-38	310		J2-06
2.500	MB7533-50	MB7533-75	MB7533-38	360		J2-06
3.000	MB7537-50	MB7537-75	MB7537-38	390		J2-06
3.500	MB7543-50	MB7543-75	MB7543-38	430		J2-10
4.000	MB7547-50	MB7547-75	MB7547-38	475		J2-10
4.500	MB7553-50	MB7553-75	MB7553-38	500		J2-10

*Orifice is not drilled in bushings with extra stock.
 To order a MANIFOLD STYLE bushing with an O-Ring Seal, add the suffix number "68" to the bushing part number.
 Example: MB7537-68.

NOTE: When machining is required at the tip of a sprue bushing, add the suffix "ES" to the bushing part number. Example: MB7547-50ES

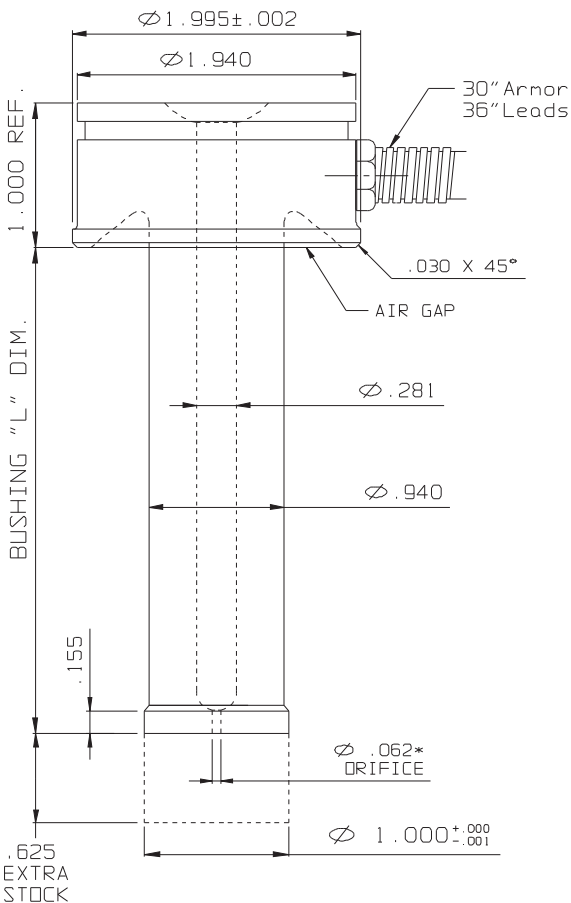

1.000 DIA. SPRUE BUSHING

STANDARD SIZES

L	½ SPH. RAD.	¾ SPH. RAD.	FLAT TYPE	Watts	Volts	T/C
1.375	MB1023-50	MB1023-75	MB1023-38	345	240	J2-06
1.875	MB1027-50	MB1027-75	MB1027-38	365		J2-06
2.375	MB1033-50	MB1033-75	MB1033-38	395		J2-06
2.875	MB1037-50	MB1037-75	MB1037-38	440		J2-06
3.375	MB1043-50	MB1043-75	MB1043-38	460		J2-10
3.875	MB1047-50	MB1047-75	MB1047-38	485		J2-10
4.375	MB1053-50	MB1053-75	MB1053-38	510		J2-10
4.875	MB1057-50	MB1057-75	MB1057-38	535		J2-10
5.375	MB1063-50	MB1063-75	MB1063-38	560		J2-10
5.875	MB1067-50	MB1067-75	MB1067-38	585		J2-10
6.375	MB1073-50	MB1073-75	MB1073-38	610		J2-10
6.875	MB1077-50	MB1077-75	MB1077-38	635		J2-10
7.375	MB1083-50	MB1083-75	MB1083-38	660		J2-14
7.875	MB1087-50	MB1087-75	MB1087-38	685		J2-14
8.375	MB1093-50	MB1093-75	MB1093-38	710	J2-14	
8.875	MB1097-50	MB1097-75	MB1097-38	735	J2-14	

*Orifice is not drilled in bushings with extra stock.
 A replaceable T/C is installed with each bushing.
 To order a MANIFOLD STYLE bushing with an O-Ring Seal, add the suffix number "68" to the bushing part number.
 Example: MB1073-68.

NOTE: When machining is required at the tip of a sprue bushing, add the suffix "ES" to the bushing part number. Example: MB1033-38ES.

SCALE 3/4:1

FOR SPECIAL SIZES AND/OR DIMENSIONS, PLEASE CALL MDI.